



Raindrops

Article Number: 100.70.01

Thank you for purchasing the Raindrops Battery operated mirror from Pebble Grey. Please read these instructions carefully before installation to ensure safe use of this product and retain these instructions for future reference.

- This is a battery operated item, do not connect to any mains supply.
- Fixing holes must be clear of any obstruction (e.g. Cables, gas or water pipes) within the mounting surface.
- Please contact a qualified electrician if in doubt regarding the installation process.

Specification:

- IP44 rated for safe use in bathroom zones 2 & 3
- Input: 12Vdc - 8 x C type battery

Pack Contents:

- Fixing Screws x 2
- Instruction Leaflets x 1

INSTALLATION PROCESS

1. Drill the finish holes (2mm) on the mounting surface according to Figure 1.
2. Secure with the screws provided and hang the mirror from the rear of the bracket.
3. Unscrew the battery compartment, and pull the compartment at the bottom of the mirror to change the batteries.
4. Once you have replaced the batteries secure the compartment back in place using the screws.

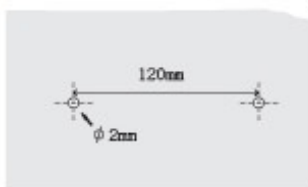
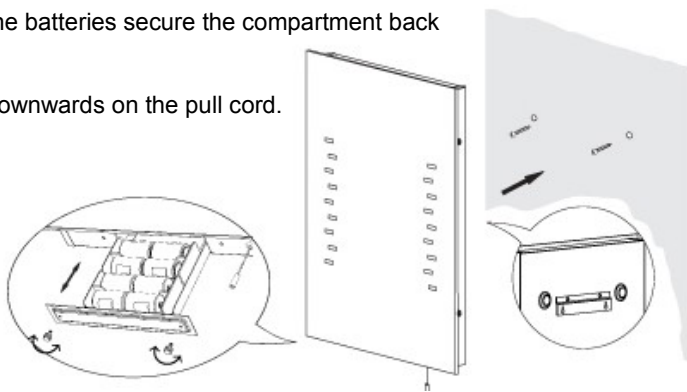

Figure 1

To activate your new mirror pull downwards on the pull cord.



BATHROOM ZONES

1. IP rating stands for 'Ingress Protection' and is always followed by two numbers. These two numbers refer to the level of protection the product has and it is important that you choose fittings with the correct ratings according to where they are situated in the bathroom.
2. Your Pebble Grey mirror has been specially protected against the ingress of moisture and is manufactured to meet IP44 standards, thereby making it suitable for use in Zones 2 and 3 of your bathroom.
3. With reference to the diagram below, Zone 2 is an area stretching 0.6m outside the perimeter of the bath and to a height of 2.25m from the floor.

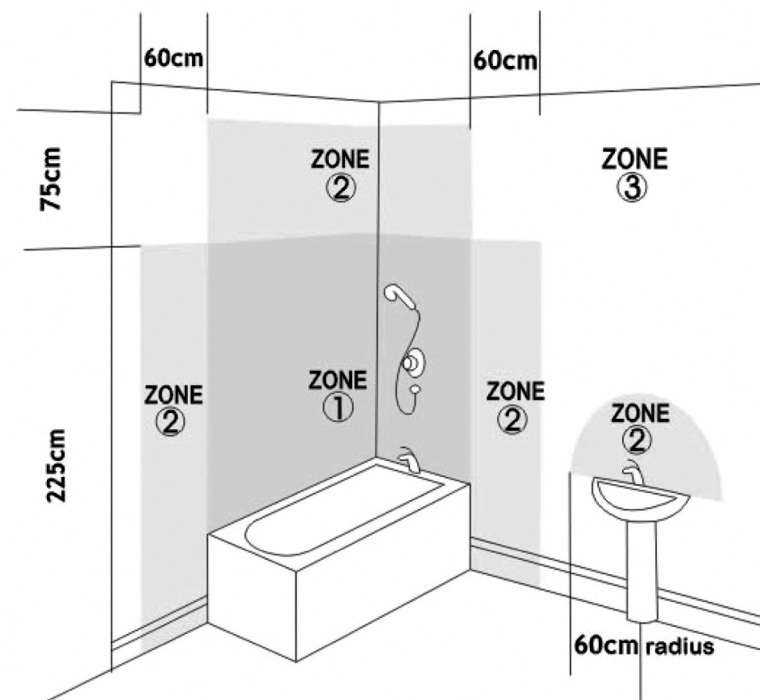

0845 6044 249
www.pebblegrey.co.uk